

Proprietary rights are included in the information disclosed herein. This information is submitted in confidence and neither the document nor the information disclosed herein shall be reproduced or transferred to other documents for manufacturing or for any other purpose except as specifically authorized in writing by ARE Telecom & Wind.

REVISIONS			
REV.	DESCRIPTION	DATE	APPROVED
A	initial release	4/7/21	MGC
B	Revised weight units	9/21/21	MGC
C	Revised flange bolt diameters.	6/7/22	MGC

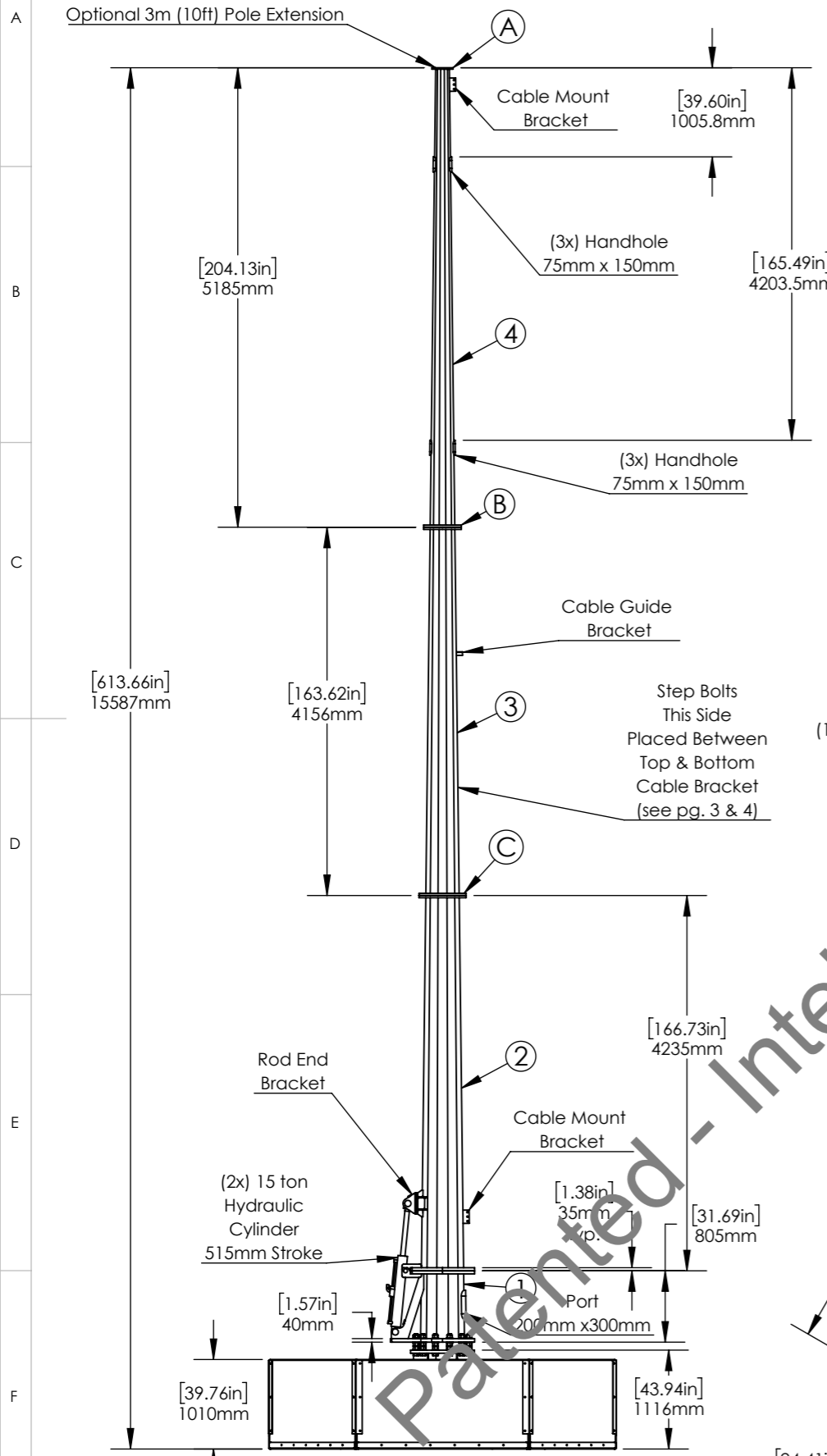

A. Flange

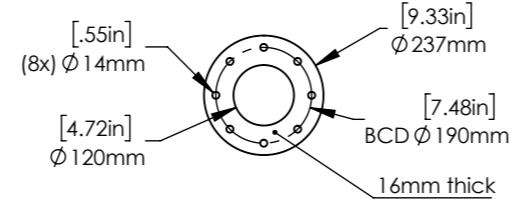

B. Flange

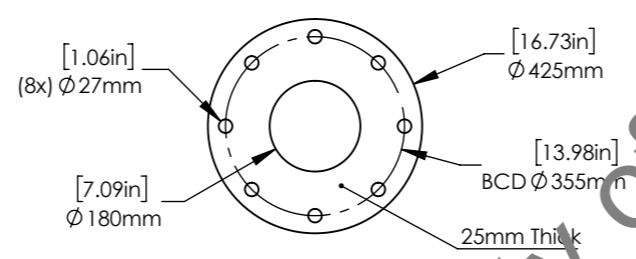

C. Flange

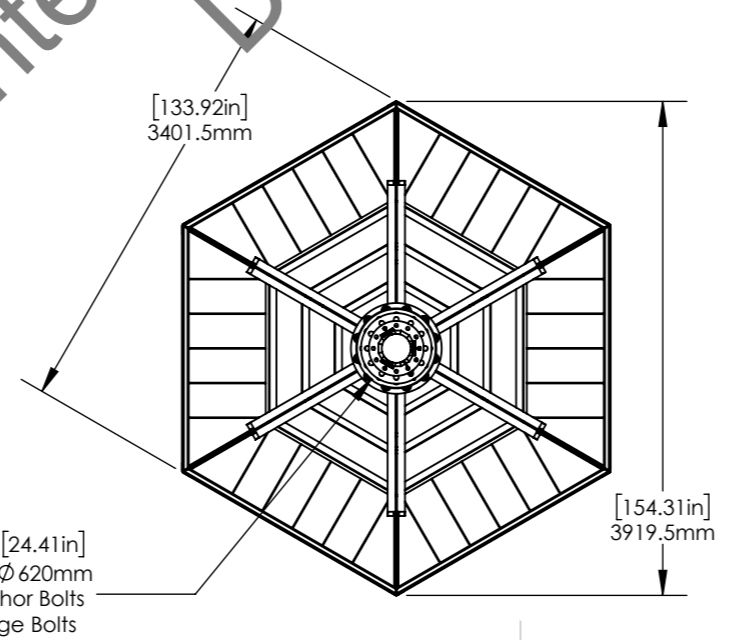
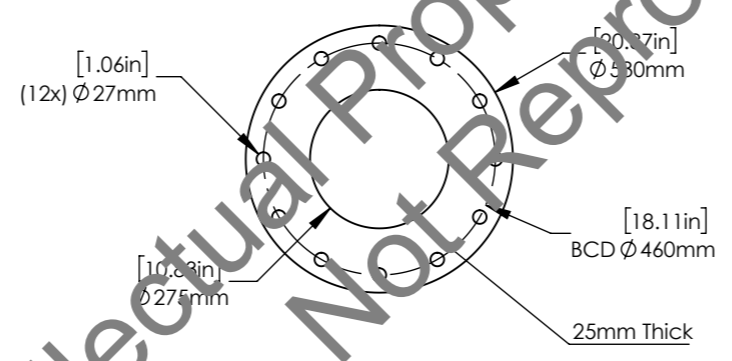

- Survival Wind Speed: Per Code
 - Structure Class - Per Code
 - Topographic - Per Code
 - Exposure - Per Code
- Design and Welding Codes:
 - FIA 22-G
 - AVIS D1.1
- Material (or equivalent)
 - Pole: Q355 (ASTM A572 GR50)
 - Baseplate: Q355 (ASTM A572 GR50)
 - Splice Plates/ Flanges: Q355 (ASTM A572 GR50)
- (A) Flange/ Rod End Bracket Bolts: (8X) M12x1.75 x 60mm - GR 8.8
 - (1X) Nut (2X) Washer
 - Optional (1/2-13 x 2.375in GR A325)
 - Hot Dip Galv. per ASTM F2329
- (B-C) Flange Bolts: (20X) M24x3 x 100mm - GR 8.8
 - (1X) Nut (2X) Washer
 - Optional (1-8 x 4in GR A325)
 - Hot Dip Galv. per ASTM F2329
- Hing Flange Bolts: (12X) M36x4 x 125mm - GR 8.8
 - (3x) Nut (4x) Washer
 - Optional (1 1/2-6 x 5in) Grade ASTM F1554 G55)
 - Hot Dip Galv. per ASTM F2329
- Anchor Bolts: (12X) M36x4 x 225mm - GR 8.8
 - (3x) Nut (4x) Washer
 - Optional (1 1/2-6 x 9in) Grade ASTM F1554 G55)
 - Hot Dip Galv. per ASTM F2329
- Pole has 12 sides
- Finish: Hot dip Galvanizing per ASTM A123

10. Pole Section Details

Pole Section	#1	#2	#3	#4
Thickness - (mm)/ (in)	0.197/ 5	0.197/ 5	0.197/ 5	0.197/ 5
Length - (m)/ (ft)	0.805/ 2.64	4.235/ 13.9	4.156/ 13.64	5.185/ 17
Top Dia. - (mm)/ (in)	478/ 18.8	377/ 14.8	278/ 10.94	155/ 6.1
Bottom Dia. - (mm)/ (in)	495/ 19.5	476/ 18.74	376/ 14.8	277/ 10.9
Min Slip - (mm)/ (in)		NA	NA	NA
Section Weight (kg)/ (lb)	313/ 689	392/ 862	221/ 486	169/ 372

Maximum Additional Weight to Top of Pole: 275 kg/1265 lb

CAD-generated drawing do not manually update

ARE Telecom + Broadband 1041 Grand Ave., #213 St. Paul, MN 55105 (651) 330-1263 www.aretelcom.com

APPROVALS	DATE
DRAWN MGC	6/7/22
CHECKED	
RESP ENG	
MFG ENG	
QUAL ENG	

15.6m 4SF Hyd AFS400

CAD file: Details and dimensions not shown on this drawing can be found in CAD file.

scale NA rev. C size NA sheet 1 of 4